

## S-Corner PVC 90° CI / WA

### Prefabricated PVC corners

---

<b>Product Description</b>	S-Corner PVC 90° CI / WA are made of premium-quality PVC by injection moulding procedure.
----------------------------	---

---

<b>Uses</b>	S-Corner PVC 90° CI / WA are used as prefabricated corners on Sarnafil® G/S and Sikaplan® PVC flat roof systems.
-------------	--

---

<b>Characteristics / Advantages</b>	<ul style="list-style-type: none"><li>■ Outstanding resistance to weathering, including UV irradiation</li><li>■ Ease of application</li><li>■ Excellent weldability</li><li>■ Recyclable</li></ul>
-------------------------------------	---

---

#### Tests

---

<b>Approvals / Standards</b>	■ Quality management system EN ISO 9001/14001
------------------------------	---

---

#### Product Data

---

##### Form

---

<b>Appearance</b>	Surface: smooth
-------------------	-----------------

---

<b>Colour</b>	Light grey (nearest RAL 7047)
	Other colours on request

---

<b>Packaging</b>	Bag with 10 pieces
------------------	--------------------

---

##### Storage

---

<b>Storage Conditions</b>	S-Corner PVC 90° CI / WA shall be stored in dry conditions.
---------------------------	---

---

<b>Shelf-Life</b>	S-Corner PVC 90° CI / WA does not expire during correct storage.
-------------------	--

---

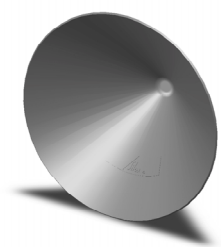

S-Corner PVC 90° CI

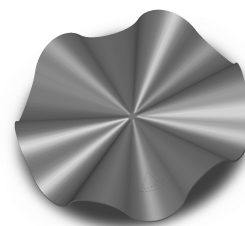

S-Corner PVC 90° WA

Art. No.	Description	Diameter	Colour	Uses	Material thickness
183669	S-Corner PVC 90° CI	160 mm	Light grey	Inside Corner	1.5 mm
183670	S-Corner PVC 90° WA	160 mm	Light grey	Outside corner	1.5 mm

## Technical Data

**Material Basis** Polyvinyl chloride (PVC)

## System Information

**System Structure** Compatible products: All Sikaplan® and Sarnafil® PVC flat roof waterproofing membranes

## Application Conditions / Limits

**Temperature** The use of S-Corner PVC 90° CI / WA is limited to geographical locations with average monthly minimum temperatures of -50 °C. Permanent ambient temperature during use is limited to +50 °C.

## Installation Instructions

**Installation Method** According to the valid installation instructions for Sarnafil® and Sikaplan® flat roof waterproofing membranes.

## Notes on Installation / Limits

Installation works to be carried out only by Sika instructed contractors for roofing.  
 Temperature limits for the installation of the S-Corner PVC 90° CI / WA:  
 Substrate temperature: -30 °C min. / +60 °C max.  
 Ambient temperature: -20 °C min. / +60 °C max.  
 Installation of some ancillary products, e.g. contact adhesives / cleaners is limited to temperatures above +5 °C. Please observe information given by Product Data Sheets.  
 Special measures may be compulsory for installation below +5 °C ambient temperature due to safety requirements in accordance with national regulations.

<b>Value Base</b>	All technical data stated in this Product Data Sheet are based on laboratory tests. Actual measured data may vary due to circumstances beyond our control.
<b>Local Restrictions</b>	Please note that as a result of specific local regulations the performance of this product may vary from country to country. Please consult the local Product Data Sheet for the exact description of the application fields.
<b>Ecology, Health and Safety Information</b>	A Safety Data Sheet following EC-Regulation 1907/2006, Article 31 is not needed to bring the product to the market, to transport or to use it. The product does not damage the environment when used as specified.
<b>REACH</b>	<p><b>European Community Regulation on chemicals and their safe use (REACH: EC 1907/2006)</b></p> <p>This product is an article within the meaning of Regulation (EC) No 1907/2006 (REACH). It contains no substances which are intended to be released from the article under normal or reasonably foreseeable conditions of use. Therefore, there are no registration requirements for substances in articles within the meaning of Article 7.1 of the Regulation.</p> <p>Based on our current knowledge, this product does not contain SVHC (substances of very high concern) from the candidate list published by the European Chemicals Agency in concentrations above 0.1 % (w/w).</p>
<b>Protective Measures</b>	Fresh air ventilation must be ensured, when working (welding) in closed rooms. Local safety regulations must be observed.
<b>Transportation Class</b>	The product is not classified as hazardous good for transport.
<b>Disposal</b>	The material is recyclable. Disposal must be according to local regulations. Please contact your local Sika sales organisation for more information.
<b>Hälsa &amp; Miljö</b>	
<b>Hälsa &amp; Miljö Lagstiftning</b>	<p>Se separat säkerhetsdatablad.</p> <p>Informationen och i synnerhet rekommendationerna avseende applikation och slutanvändning av Sika-produkterna lämnas i god tro baserat på Sikas nuvarande kunskap och erfarenhet av produkterna när dessa lagras, hanteras och används under normala förhållanden på ett korrekt sätt. I praktiken kan differenserna i material, underlag och den aktuella platsen variera på sådant sätt att ingen garanti vad gäller användbarhet eller lämplighet för ett visst ändamål kan lämnas. Med hänsyn härtill kan något rättsligt ansvar av vad slag det må vara varken härledas från denna information eller från någon skriftlig rekommendation eller i övrigt beträffande produkten lämnade råd. Hänsyn måste vid användningen även tas till tredje mans ägande och andra eventuella rättigheter. Alla order accepteras under förutsättningen av att Sikas aktuella försäljnings- och leveransbestämmelser är gällande. Användaren skall alltid använda sig av den senaste utgåvan av den aktuella produktens tekniska datablad, vilket kan erhållas vid förfrågan eller på hemsidan <a href="http://www.sika.se">www.sika.se</a>.</p>



Sika Sverige AB  
 Domnarvsgatan 15  
 Box 8061  
 SE-163 08 Spånga  
 Sverige

Tel. +46 8 621 89 00  
 Fax +46 8 621 89 89  
[www.sika.se](http://www.sika.se)

